

## Proposed Main Floor Shop Area

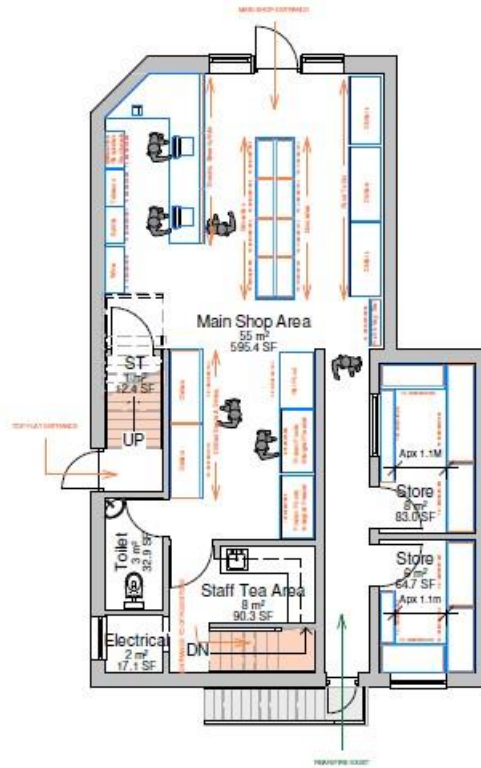

## Ground Floor - Main Shop Area

1 : 100

ARCHITECTURAL GENERAL NOTES	Purpose Of Issue: <i>Alcohol Licensing</i>	<i>*** Please Note: All Planning Permission architectural drawings are not suitable for Building Regulation applications or for construction purposes.</i>			
<p>1. THESE DRAWINGS INDICATE IN GENERAL THE PROJECT IN TERMS OF ARCHITECTURAL DESIGN INTENT. THE DIMENSIONS OF THE BUILDING, THE MAJOR ARCHITECTURAL ELEMENTS AND TYPE OF STRUCTURAL, MECHANICAL AND ELECTRICAL SYSTEMS. THE DRAWINGS DO NOT NECESSARILY INDICATE OR DESCRIBE ALL WORK REQUIRED FOR FULL PERFORMANCE AND COMPLETION OF THE REQUIREMENTS OF THE CONTRACT DOCUMENTS AS INDICATED OR DESCRIBED. THE CONTRACTOR SHALL FURNISH ALL ITEMS REQUIRED FOR THE PROPER EXECUTION AND COMPLETION OF THE WORK.</p> <p>2. THE CONTRACTOR SHALL CONDUCT HIS OWN SITE SURVEY OF THE EXISTING GROUND AND CURB ELEVATIONS (LEVELS) AND REPORT ACTUAL ELEVATIONS (LEVELS) TO THE ENGINEER.</p> <p>3. ONLY WRITTEN DIMENSIONS IN ALL CASES SHALL BE FOLLOWED.</p>	<p>HOSANNAH'S LIMITED</p> <p>www.hosannahs.com</p>		<p>Client: Nilani, Nirajan Thavarasa                  Sheet: Ground Floor General Arrangement</p>	<p>Date: 23/04/2021                  Project Reference Number: HL2355</p>	<p>Scale (@ A3): 1 : 100</p>
			<p>Project Type: Nursery to Shop Conversion                  Location: 23 Shingrig Rd, Nelson, CF46 6DY</p>	<p>Drawn By: LA                  Drawing Number: A99</p>	<p>REV: 1</p>